

ESTABLISHING A **NEW STANDARD** IN THE FOODSERVICE INDUSTRY.

## KEY FEATURES

### •Intuitivo Ambient

Combining Machine Learning with Computer Vision, Intuitivo is building a unique infrastructure that allows installation of thousands of A-POPs at an unprecedented speed and cost.

### •High-Speed Secure Pop-Out Cameras

Three external cameras (two on top, one on the side) capturing at 60 frames per second for reliable capture of product purchases.

### •Full Capacity

Maximizing the space of the cabinet, we create a solution that allows the use of the cabinet's maximum capacity. Providing 90% of the interior volume usage for product display.

### •Standard LED Lighting System

Ultra bright low energy interior LED illumination system provides optimal merchandise display visibility. Low profile, door mounted, clip-in LED design.

### •Southco V9 Smart Lock

These units can only be unlocked via Intuitivo when cabinet is powered and connected. A Banana Jack will be available for manual unlocking towards the end of 2024.

### •Roller Base for Easy Installation

The cabinet is equipped with a roller base, allowing for effortless movement and precise placement during installation, plus 4 levelling legs required for cabinet stability.

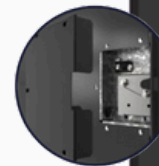

# Intuitivo. Meet them halfway.



With Intuitivo you will be super close to your customers, through thousands of autonomous points of purchase powered by AI and Computer Vision.



## Features



3 secure pop-out cameras 'outside cabinet' [2 top + 1 side]. High speed 60 x frames per second.



Cloud based product recognition and transaction processing reduces hardware cost & data accessibility.



QR code payment solution uses consumer's smart phone for transactions.

Available in large VR27 Cooler & VA27 Ambient models, for refrigerated & other sales merchandise.

## Deep Tech and a Clear Vision

Their technology allows them to train our Intuitivo's Computer Vision Pipeline on complete brand portfolios at an unprecedented speed and cost.

This will enable you to create as many planograms as you want, which will allow you to understand your consumers buying behaviors and adjust your business strategies accordingly.



## Perfect Purchases in Seconds

Intuitivo's Autonomous Points of Purchase, A-POPs, are the most effective way of bring your products closer to your customers, offering them a seamless shopping experience and having one-on-one conversations with them.

**Building the Infrastructure  
for the Future of Retail.**

ESTABLISHING A **NEW STANDARD** IN THE FOODSERVICE INDUSTRY.

## PRODUCT VIEWS

TOP VIEW

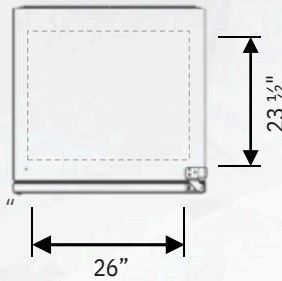

FRONT VIEW

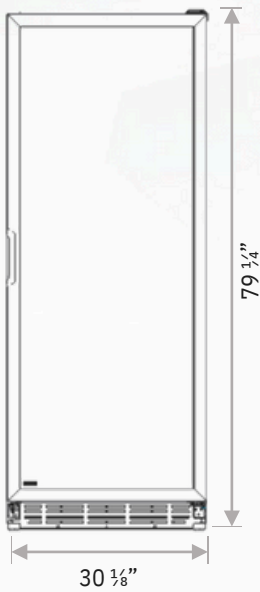

SIDE VIEW

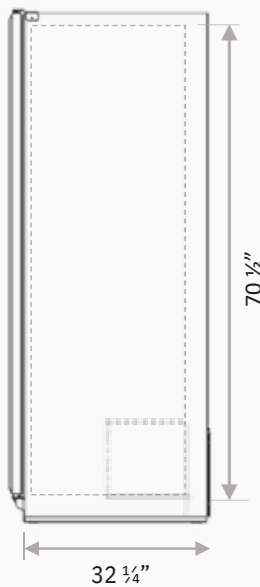

## TECHNICAL SPECIFICATIONS

### Exterior Dimensions

H: 79 1/4"	201 cm
W: 30 1/8"	77 cm
D: 32 1/4"	82 cm

### Interior Dimensions

H: 70 1/2"	179 cm
W: 26 5/8"	68 cm
D: 28"	71 cm

### Usable Interior Capacity

H: 69 1/2"	176 cm
W: 26"	66 cm
D: 23 1/2"	59 cm

### Usable Volume

28 ft<sup>3</sup>  
792 lts

Doors	Door Construction	Shelves	Shelves Size
1	Plastic Frame	7	D: 25 7/8" 63 cm W: 23 5/8" 60 cm

**External Material** Pre-painted Steel

**Internal Material** Pre-painted Steel

## CABINET PERFORMANCE DATA

### Air Flow Fan Motor

6 to 8 Watts

### Energy Consumption

500 Wh/24h

## ELECTRICAL DATA

### Power Supply

115V/60 Hz

### AMPS

1.4 A

### Lighting

253.4 Lux Output  
3 Modules  
29 LED per module

### Plug Type

NEMA 5-15P

### Controller

Raspberry  
IPV4

### Cord length

118" (300 cm)

## CAPACITY\*\*

Large capacity cabinet for ambient products such as snacks and other consumables.

### Usable Volume

28 ft<sup>3</sup>  
792 lts

## LOGISTIC DATA

### Trailer Loads

20':	21
40':	42
53':	52

### Unit Weight with Packaging

240.5 lb 109 kg

### Packaged Dimensions

H: 82 1/2"	210 cm
W: 32 1/8"	82 cm
D: 32 1/2"	78 cm

## ADDITIONAL FEATURES



> Suitable size for RTC EcoTrac® Spring Glide [12 + 20 oz.]



> Castles' S1U2 unattended payment system  
**\*Available in 2025**



> Pop-Out Camera Housing fitted with an external spring system and integrated into the cabinet frame for optimal security



> Price Kit available for shelf display

### Customer service and warranty

Three-year limited warranty, includes parts and labor.  
An additional two-year warranty is issued on the compressor (USA & Canada only).  
Operators must follow installation and operational guidelines per Imbera User's Manual.  
Each cooler must be connected directly to a single power supply, otherwise warranty will be voided.  
Customer service: 866.548.5770

\*Dimensions rounded up to the nearest inch or centimeter.

\*Specifications subject to change without notice.

\*H: Height, W: Width, D: Depth

\*\*Product capacity expressed at its highest level.